

| KEY | |
|-----------|--|
| KEY | DESCRIPTION |
| AC | AIR CONDITIONING CONDENSER. WHERE ON BALCONY CONCEAL IN FULL HEIGHT VENTILATION CUPBOARD WITH LOUVRE DOORS. |
| BIR | BUILT IN ROBE |
| BL | BOLLARD |
| BR | BROOM/TALL CUPBOARD |
| BW | STEEL FRAMED BALUSTRADE WALL - SHS COLUMNS AD BEAMS CLAD WITH PREFINISHED CFC SHEETING SB-2 FIXED ATOP BW. |
| CH | TRIPLE WASTE CHUTE SYSTEM |
| CJ | CONSTRUCTION JOINT |
| COL | STRUCTURAL CONCRETE COLUMN TO ENG'S DTLS |
| CT | COOKTOP (GAS) |
| D.# | DOOR. REFER DOOR TYPE SCHEDULE W.D.A.601 FOR DTLS OF DOOR TYPES |
| DC200 | 90/90/90 FRL. REFER ENG'S DTLS. REFER ACOUSTIC ASSESSMENT BY VIPAC FOR UNDERLAY AND INSULATION REQUIREMENTS |
| DC250 | 120/120/120 FRL. REFER ENG'S DTLS. REFER ACOUSTIC ASSESSMENT BY VIPAC FOR UNDERLAY AND INSULATION REQUIREMENTS |
| DM | DOORMAT |
| DR | MACHINE DRYER SPACE |
| DW | DISHWASHER |
| ECR | ELECTRICAL & COMMUNICATIONS RISER CUPBOARD |
| FC | FEATURE ARCHITECTURAL COLUMN TO ENG'S DTLS |
| FH | FIRE HYDRANT RISER |
| FIP | FIRE INDICATOR PANEL |
| FT | FLOOR TRAP |
| FTR | FASCIA TRUSS TO ENG'S DTLS |
| GA | IN-GROUND GREASE ARRESTOR |
| GL | GLASS FULLY FRAMED BALUSTRADE TO 1050mm AFL. HARKK VIEW SYSTEM OR SIMILAR |
| GL-O | OPAQUE GLAZED BALUSTRADE - HARKK PRIVACY WITH HANDRAIL SYSTEM OR SIMILAR |
| HR | 50mm HANDRAIL IN STAIR FIXED TO CENTRAL PRECAST WALL. HEIGHT MIN 865mm ABOVE NOSING. |
| HR-L | 50mm HANDRAIL AND BALUSTRADE IN STAIR ON LANDING. HEIGHT MIN 1000mm ABOVE FFL. |
| L | LINEN CUPBOARD |
| LD | LINEAR DRAIN |
| LVR | VERTICAL PRIVACY LOUVRE AS PER DTLS ON WINDOW SCHEDULE W.D.A.600 |
| MSB | MAIN SWITCH BOARD |
| NBN | NBN/DATA CABINET |
| OBS | OVER BONNET STORAGE UNIT - 1000mm CLEAR - 1100h x 2400w x 810d (TOTAL HEIGHT 2320) |
| OF | OVERFLOW DEVICE AS DETAILED IN BOX GUTTER TABLE |
| P | PANTRY CUPBOARD |
| PC-B | PRECAST CONCRETE PIGMENTED TO DARK GREY COLOUR TO SELECTION |
| PC-N | PRECAST CONCRETE WITH NO PIGMENT - NATURAL |
| PC-W | PRECAST CONCRETE PIGMENTED TO OFF-WHITE COLOUR TO SELECTION |
| PJ | PANEL JOINT - REFER ENG'S DWGS FOR DTLS |
| PL | GRC PLANTER BOX. MIN HEIGHT 800mm AFL. W. NO FOOTHOLDS |
| R | REFRIGERATOR SPACE |
| RC | RECESSED CEILING AT DOORS AND WINDOWS FOR CONCEALED CURTAIN TRACK OR BLIND PELMET |
| RH | RANGEHOOD WITH DUCTING TO OUTSIDE |
| RWT | RAINWATER TANK - REFER CIVIL PLANS FOR DTLS |
| SB-1 | 100mm WIDE HORIZONTAL FLAT STEEL BALUSTRADE TO INTERNAL WALKWAYS 1050mm AFL |
| SB-2 | STEEL FRAMED BALUSTRADE ATOP "BW" TO WEST ELEVATION - SEE SECTION DETAIL "BALCONY EDGE - WEST" FOR DETAILS. 600h FOR A TOTAL BALUSTRADE HEIGHT OF 1600mm AFL |
| SB-3 | 100mm WIDE VERTICAL FLAT STEEL SCREEN TO EAST FACING FIRST FLOOR BALCONIES. 700w x 1700h |
| SHS | SHS COLUMN TO ENG'S DTLS |
| ST | FEATURE STEEL COLUMNS TO ENG'S DTLS |
| TGSI | TACTILE GROUND SURFACE INDICATORS INSTALLED IN ACCORDANCE WITH D3.8 OF BCA & AS 1428.4.1 |
| UBO | UNDER BENCH OVEN |
| W.# | WINDOW. REFER WINDOW TYPE SCHEDULE W.D.A.600 FOR DTLS OF WINDOW TYPES. |
| WASTE CH. | WASTE CHUTE IN RISER. FIRE RATED TO 1HR. HOPPER DOORS 1HR FIRE RATING |
| WIR | WALK IN ROBE |
| WM | WASHING MACHINE SPACE WITH FLOOR TRAP UNDER AND TAPS |
| WO | WALL OVEN |
| WS | WHEEL STOP TO CIVIL DTLS |

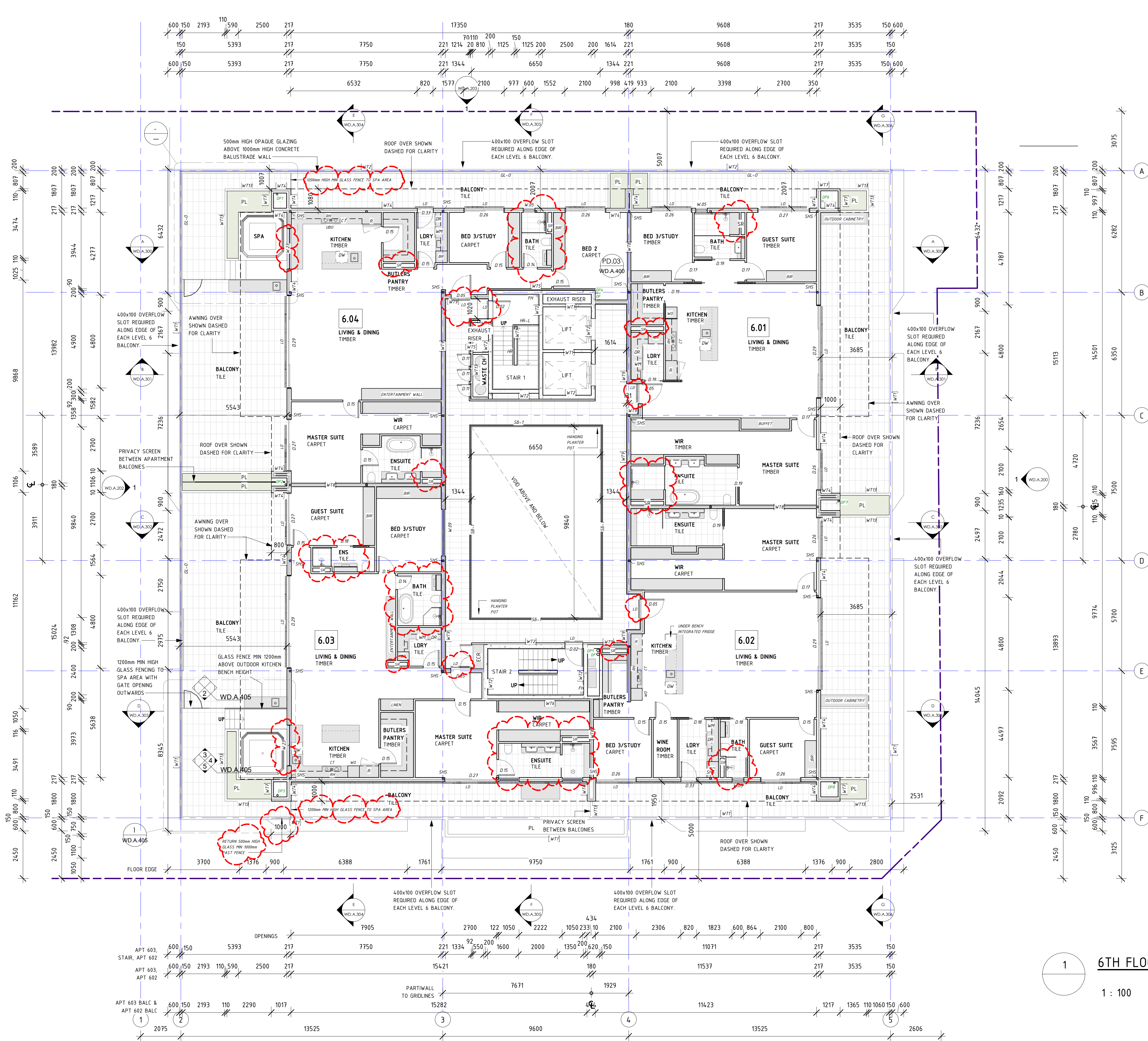

| WALL SCHEDULE | | | | | |
|---------------|--|--|-------------|---|--|
| TAG | CONSTRUCTION | FINISH | FRL | INSULATION | ACOUSTIC |
| WT1 | 150mm PRECAST CONCRETE PANEL | STANDARD GREY INTERNALLY, REFER ELEVATIONS FOR EXTERNAL CONCRETE COLOURS | 120/120/120 | REFER TO WT5 OR WT6 FOR WALL INSULATION WHERE APPLICABLE | Rw 50 + Rw + Ctr 50 IF NO LINING. REFER TO WT5 OR WT6 FOR SOU APPLICATIONS |
| WT2 | 200mm PRECAST CONCRETE PANEL | STANDARD GREY INTERNALLY, REFER ELEVATIONS FOR EXTERNAL CONCRETE COLOURS | 180/180/180 | REFER TO WT5 OR WT6 FOR WALL INSULATION WHERE APPLICABLE | Rw 50 + Rw + Ctr 50 IF NO LINING. REFER TO WT5 OR WT6 FOR SOU APPLICATIONS |
| WT3 | 100mm PRECAST CONCRETE PANEL | STANDARD GREY INTERNALLY, REFER ELEVATIONS FOR EXTERNAL CONCRETE COLOURS | 90/90/90 | REFER TO WT5 OR WT6 FOR WALL INSULATION WHERE APPLICABLE | NA |
| WT4 | HEBEL WALL (NON-LOADBEARING) - STEEL FRAMED. 75mm HEBEL, 50mm TOP HAT, 92mm STEEL STUD. 2 LAYERS 16mm FYRCHECK PLASTERBOARD FINISH INTERNALLY. | PAINTED, HEBEL RENDERED AND PAINTED TO 3 COAT SYSTEM | 90/90/90 | 90mm R2.5 BRADFORD GW NON-COMBUSTIBLE INSULATION WITHIN 92mm STEEL STUD. FOIL BACKED SIGILATION FIXED TO STEEL STUDS. | Rw 50 + Rw + Ctr 50 |
| WT5 | 64mm STEEL STUDS AT 600mm MAX CTS. TO WT1 OR WT2 PARTY WALLS AND EXTERNAL WALLS. 25mm CAVITY (DISCONTINUOUS CONSTRUCTION) | FLUSHED & PAINTED | ---/---/--- | 90mm R2.5 BRADFORD GW NON-COMBUSTIBLE INSULATION BATTS | WHEN COMBINING WT1 OR WT2 WITH WT5 AND 25mm CAVITY, Rw 50 AND Rw + Ctr 50 ACHIEVED |
| WT6 | 92mm STEEL STUDS AT MAX 600mm CTS. USED FOR INTERNAL WALLS. | LINE WITH 10mm PLASTERBOARD. FLUSH & PAINT TYP. | ---/---/--- | R2.0 BRADFORD GW NON-COMBUSTIBLE INSULATION BATTS TO INTERNAL WALLS WITHIN SOUS | NA |
| WT6a | 92mm STEEL STUDS AT MAX 600mm CTS. USED FOR INTERNAL WALLS. LINE BOTH SIDES WITH 16mm FYRCHECK PLASTERBOARD. | FLUSH AND PAINT TYP. | ---/60/60 | R2.0 BRADFORD GW NON-COMBUSTIBLE INSULATION BATTS. | NA |
| WT7 | 92mm STEEL STUDS AT MAX 450mm CTS. FOR BATHROOM & LAUNDRY PODS. | LINE W. AQUACHECK PLASTERBOARD. WATERPROOF & TILE AS PER SPECIFICATIONS | ---/---/--- | R2.0 GW INSULATION BATTS (11kg/m³) | NA |
| WT8 | LIGHTWEIGHT PARTYWALL. CSR1385. TWO ROWS OF 64mm STEEL STUDS WITH 20mm CAVITY. ONE LAYER OF 16mm FYRCHECK TO BOTH SIDES OF WALL | FLUSH AND PAINT TYP. | 90/90/90 | 75mm R17 GW ACOUSTIGARD NON-COMBUSTIBLE TO BOTH STUDS | Rw 59 + Rw + Ctr 50 |
| WT8a | LIGHTWEIGHT PARTYWALL. CSR1385. TWO ROWS OF 64mm STEEL STUDS WITH 80mm CAVITY. ONE LAYER OF 16mm FYRCHECK TO BOTH SIDES OF WALL | FLUSH AND PAINT TYP. | 90/90/90 | 75mm R17 GW ACOUSTIGARD NON-COMBUSTIBLE TO BOTH STUDS | Rw 59 + Rw + Ctr 50 |
| WT9 | LIGHTWEIGHT EXTERNAL WALL (INTERNAL WALKWAYS). CSR1385 AT PER WT8 CONSTRUCTION WITH 6mm FIBRE CEMENT SHEETS ON 35mm TOP HATS EXTERNALLY. | RENDER AND PAINT EXTERNALLY. | 90/90/90 | 75mm R17 GW ACOUSTIGARD NON-COMBUSTIBLE TO BOTH STUDS | Rw 59 + Rw + Ctr 50 |
| WT10 | 2100h FENCING | GOOD NEIGHBOUR | ---/---/--- | NA | NA |
| WT11 | 600mm PILES WITH 100mm SHOTCRETE INTERNALLY | | 180/180/180 | NA | NA |
| WT12 | SELECTED BLUESTONE TILE FIXED TO PRECAST WALL TO MANUF. DTLS | | ---/---/--- | NA | NA |
| WT13 | 110mm FIRE RATED COMMON BRICK WALL | WHERE USED INTERNALLY, LINE WITH 10mm PLASTERBOARD - FLUSH & PAINT TYP. | 90/90/90 | NA | NA |

1 6TH FLOOR PLAN
1 : 100

| REVISIONS | | |
|-----------|------------|--------------------------------------|
| ISSUE # | DATE | DESCRIPTION |
| A | 25/03/2019 | FOR BRC APPROVAL |
| B | 14/05/2019 | REVISED SET BASED ON BRC RFI PC59515 |
| D | 29/06/2019 | FOR TENDER & BRC |
| | | |
| | | |
| | | |

PROJECT ADDRESS
248 UNLEY ROAD HYDE PARK

HYDE PARK PLACE - STAGE A

CLIENT
HYDE PARK PLACE PTY LTD

CITYFY

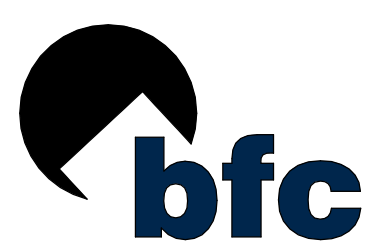

SHEET
6TH FLOOR PLAN

WD.A.108

AUTHOR
GB

CURRENT REVISION
FOR TENDER & BRC

ISSUE DATE
29/06/2019

FOR TENDER



www.gemmalea.com.au
gemma@gemmalea.com.au
LEA 39 862 391 538